



Pearmtree Hill Solar Farm

Environmental Statement

Volume 3

Figure 3.4: Indicative Environmental Masterplan

Revision 4

Application Document Ref: EN010157/APP/6.3
October 2025

Planning Act 2008
Infrastructure Planning
(Applications: Prescribed Forms
and Procedure) Regulations 2009 –
Regulation 5(2)(a)

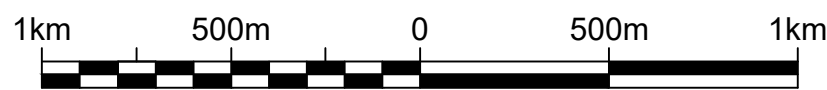
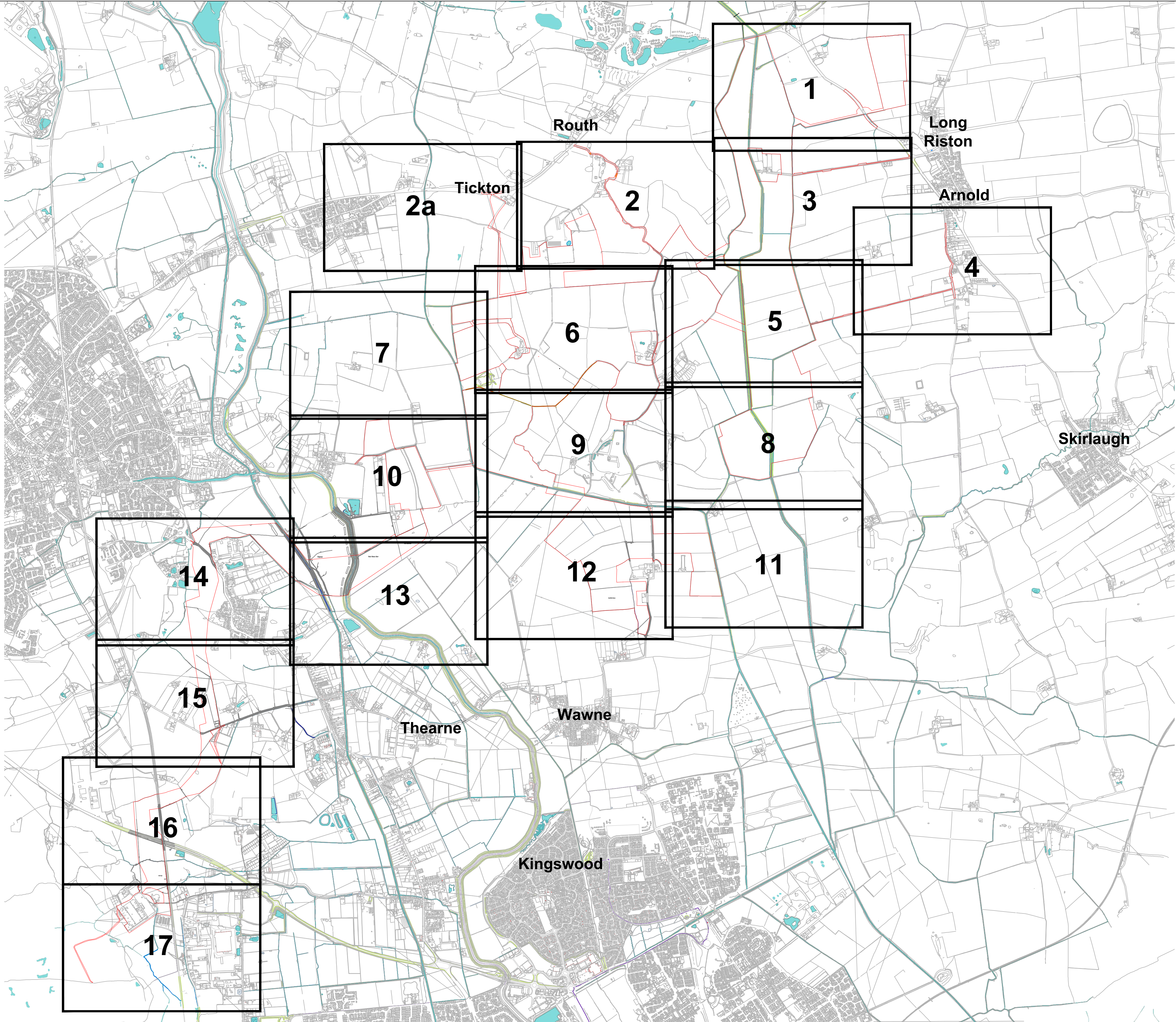

Key

Order Limits

- Notes:
- Drawing is indicative only and not for construction.
 - This drawing depicts the anticipated layout of the Proposed Development, exact details concerning the layout and dimensions of the Proposed Development will be determined and designed at detailed design stage in line with the provisions of the DCO Application (Refer to document EN010157/APP/6.3).
 - Do not scale from this drawing.

P04	29/10/25	JP	ZF	ZF	ZF
P03	28/10/25	JP	ZF	ZF	ZF
P02	08/09/25	CU	ZF	ZF	ZF
P01	10/02/25	JP	ZF	ZF	ZF
Rev	Date	By	Chkd	Appd	Authd

Client

RWE

Designer

RSK

Project Name

Peartree Hill Solar Farm

Drawing Title

Environmental Statement Volume 3, Figure 3.4: Indicative Environmental Masterplan Overview Sheet

Scale at A1
1:2500

Status
DCO Application

PINS Number
EN010157/APP/6.3

Drawing Name
0589-SHRBK-XX-XX-DR-L-1000

Coordinate System:
British National Grid

Rev
P04



A1

A165

A165

A165

Proposed species-rich hedgerow with occasional small stature hedgerow trees alongside existing Public Right of Way to provide landscape structure and softening of Proposed Development for walkers

Proposed species-rich hedgerow to avoid existing gas main easement

Proposed relaxation of hedge flailing together with hedgerow infill planting where required to provide biodiversity, screening and landscape structure

Proposed relaxation of hedge flailing together with hedgerow infill planting where required to provide biodiversity, screening and landscape structure

Proposed signage to prevent dogs running free within Mitigation area and encourage users to follow the permissive path route. If not sufficient, post and rail fencing is proposed (indicated in blue)

For continuation see sheet 3

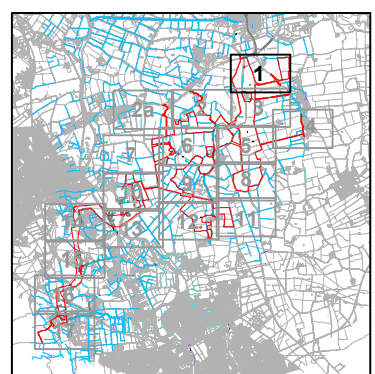

Site Plan: Not to scale

Key	Order Limits	Watercourses and Waterbodies	Proposed Switch Gear/ Spares Container	Proposed Species-rich Infill/Reinstatement Hedgerow Planting	Proposed Biodiversity Mitigation Area
Existing Features		Powerlines and Pylons	Proposed Perimeter Fencing	Proposed Legume Rich Grassland: To establish a sward between the solar panels within the fenced areas (post initial implementation)	Proposed Biodiversity Enhancement Area
Woodland, Trees and Hedgerows to be retained and protected		Proposed Development Features	Proposed Permissive Path (to be available for pedestrians only)	Proposed Field Margin Grassland: To provide habitat and food resources for wildlife. Mixes to be either Wild Bird Winter Seed or Legume Rich Grassland as recommended by Ecologist	Proposed bird box location (Refer to Appendix B in the Outline LEMP for box type)
Trees and Hedgerows to be removed to allow for construction of Proposed Development		Proposed Solar Panels	Proposed Individual Tree Planting	Proposed Flower Rich/Wet Grassland: Within Biodiversity Mitigation & Enhancement Areas. Mixes to be either flower rich grassland or wet grassland as recommended by Ecologist and dependent on site conditions	Proposed barn owl location (Refer to Appendix B in the Outline LEMP for box type)
Public Right of Way		Proposed Internal Tracks	Proposed Species-rich Hedgerow Planting		Proposed bat box location (Refer to Appendix B in the Outline LEMP for box type)
		Proposed Hybrid Pack (Inverters, Converters, BESS Units)			

The Base mapping is based upon Ordnance Survey (OS) data. Reproduced from Ordnance Survey maps by permission of Ordnance Survey on behalf of the controller of His Majesty's Stationery Office (HMSO). © Crown Copyright Ordnance Survey 2024. Licence number 0100031673.



- Notes:
- Drawing is indicative only and not for construction.
 - This drawing depicts the anticipated layout of the Proposed Development, exact details concerning the layout and dimensions of the Proposed Development will be determined and designed at detailed design stage in line with the provisions of the DCO Application (Refer to document EN010157/APP/6.3).
 - Do not scale from this drawing.

Rev	Date	By	Chkd	Appd	Authd
P04	29/10/25	JP	ZF	ZF	ZF
P03	28/10/25	JP	ZF	ZF	ZF
P02	08/09/25	CU	ZF	ZF	ZF
P01	10/02/25	JP	ZF	ZF	ZF

Client

RWE

Designer

RSK

Project Name

Peartree Hill Solar Farm

Drawing Title

Environmental Statement Volume 3, Figure 3.4: Indicative Environmental Masterplan Sheet 1 of 18

Scale at A1 1:2500	Coordinate System: British National Grid
Status DCO Application	Rev P04
PINS Number EN010157/APP/6.3	
Drawing Name 0589-SHRSK-XX-XX-DR-L-1000	



A1



For continuation see sheet 2

For continuation see sheet 3

Key

Existing Features

- Woodland, Trees and Hedgerows to be retained and protected
- Trees and Hedgerows to be removed to allow for construction of Proposed Development
- Watercourses and Waterbodies

Proposed Development Features

- Powerlines and Pylons
- Proposed Solar Panels
- Proposed Internal Tracks
- Proposed Hybrid Pack (Inverters, Converters, BESS Units)
- Proposed Switch Gear/Spares Container

Proposed Perimeter Fencing

- Proposed Permissive Path (to be available for pedestrians only)
- Proposed Permissive Path (to be available for horse riders and pedestrians)
- Proposed Individual Tree Planting

Proposed Species-rich Hedgerow Planting

- Proposed Species-rich Infill/Reinstatement Hedgerow Planting
- Proposed Legume Rich Grassland: To establish a sward between the solar panels within the fenced areas (post initial implementation)
- Proposed Field Margin Grassland: To provide habitat and food resources for wildlife. Mixes to be either Wild Bird Winter Seed or Legume Rich Grassland as recommended by Ecologist

Proposed Flower Rich/Wet Grassland: Within Biodiversity Mitigation & Enhancement Areas. Mixes to be either flower rich grassland or wet grassland as recommended by Ecologist and dependent on site conditions

Proposed Biodiversity Enhancement Area

Proposed bird box location (Refer to Appendix B in the Outline LEMP for box type)

Notes:

- Drawing is indicative only and not for construction.
- This drawing depicts the anticipated layout of the Proposed Development, exact details concerning the layout and dimensions of the Proposed Development will be determined and designed at detailed design stage in line with the provisions of the DCO Application (Refer to document EN010157/APP/6.3).
- Do not scale from this drawing.

Rev	Date	By	Chkd	Appd	Authd
P04	29/10/25	JP	ZF	ZF	ZF
P03	28/10/25	JP	ZF	ZF	ZF
P02	08/09/25	CU	ZF	ZF	ZF
P01	10/02/25	JP	ZF	ZF	ZF

Client

RWE

Designer

RSK

Project Name

Peartree Hill Solar Farm

Drawing Title

Environmental Statement Volume 3, Figure 3.4: Indicative Environmental Masterplan Sheet 2 of 18

Scale at A1
1:2500

Status
DCO Application

PINS Number
EN010157/APP/6.3

Drawing Name
0589-SHRSK-XX-XX-DR-L-1000

Coordinate System:
British National Grid

Rev
P04

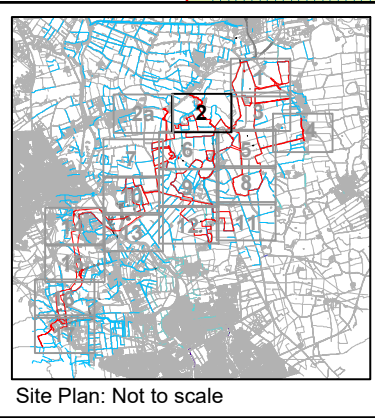

Site Plan: Not to scale

The Base mapping is based upon Ordnance Survey (OS) data. Reproduced from Ordnance Survey maps by permission of Ordnance Survey on behalf of the controller of His Majesty's Stationery Office (HMSO). © Crown Copyright Ordnance Survey 2024. Licence number 0100031673.



For continuation see sheet 3



A1

For continuation see sheet 2

For continuation see sheet 1

For continuation see sheet 4

For continuation see sheet 4

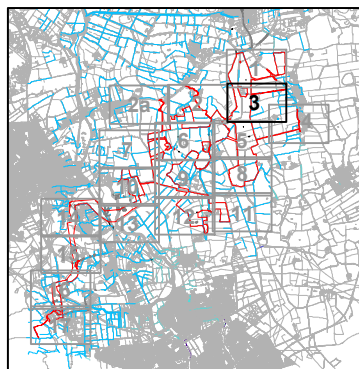

Site Plan: Not to scale

Key

Order Limits

Existing Features

Woodland, Trees and Hedgerows to be retained and protected

Trees and Hedgerows to be removed to allow for construction of Proposed Development

Public Right of Way

Watercourses and Waterbodies

Powerlines and Pylons

Proposed Development Features

Proposed Solar Panels

Proposed Internal Tracks

Proposed Hybrid Pack (Inverters, Converters, BESS Units)

Proposed Switch Gear/ Spares Container

Proposed Perimeter Fencing

Proposed Post and Wire Fencing

Proposed Permissive Path (to be available for pedestrians only)

Proposed Individual Tree Planting

Proposed Mixed Scrub Planting

Proposed Species-rich Hedgerow Planting

Proposed Species-rich Infill/Reinstatement Hedgerow Planting

Proposed Legume Rich Grassland: To establish a sward between the solar panels within the fenced areas (post initial implementation)

Proposed Field Margin Grassland: To provide habitat and food resources for wildlife. Mixes to be either Wild Bird Winter Seed or Legume Rich Grassland as recommended by Ecologist

Proposed Flower Rich/Wet Grassland: Within Biodiversity Mitigation & Enhancement Areas. Mixes to be either flower rich grassland or wet grassland as recommended by Ecologist and dependent on site conditions

Proposed Interpretation Board

Proposed Biodiversity Mitigation Area

Proposed bird box location (Refer to Appendix B in the Outline LEMP for box type)

Proposed kestrel box location (Refer to Appendix B in the Outline LEMP for box type)

Interconnecting cable routes and grid connection cable route (Habitats to be reinstated following cable installation)

Notes:

- Drawing is indicative only and not for construction.
- This drawing depicts the anticipated layout of the Proposed Development, exact details concerning the layout and dimensions of the Proposed Development will be determined and designed at detailed design stage in line with the provisions of the DCO Application (Refer to document EN010157/APP/6.3).
- Do not scale from this drawing.



Client



Designer

Project Name

Peartree Hill Solar Farm

Drawing Title

Environmental Statement Volume 3, Figure 3.4: Indicative Environmental Masterplan Sheet 3 of 18

Scale at A1

1:2500

Status

DCO Application

PINS Number

EN010157/APP/6.3

Drawing Name

0589-SHRSK-XX-XX-DR-L-1000

Coordinate System:

British National Grid

Rev

P04



For continuation see sheet 3

A1

For continuation see sheet 3

For continuation see sheet 5

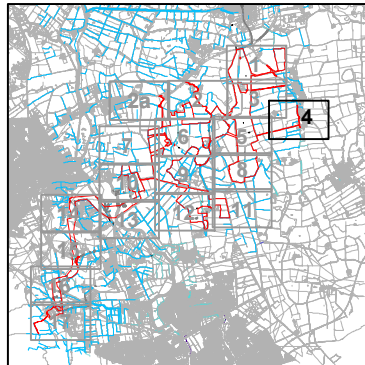

Site Plan: Not to scale

Key	
	Order Limits
	Existing Features
	Woodland, Trees and Hedgerows to be retained and protected
	Trees and Hedgerows to be removed to allow for construction of Proposed Development
	Watercourses and Waterbodies
	Powerlines and Pylons
	Public Right of Way
	Proposed Development Features
	Proposed Species-rich Hedgerow Planting

The Base mapping is based upon Ordnance Survey (OS) data. Reproduced from Ordnance Survey maps by permission of Ordnance Survey on behalf of the controller of His Majesty's Stationery Office (HMSO). © Crown Copyright Ordnance Survey 2024. Licence number 0100031673.

- Notes:
- Drawing is indicative only and not for construction.
 - This drawing depicts the anticipated layout of the Proposed Development, exact details concerning the layout and dimensions of the Proposed Development will be determined and designed at detailed design stage in line with the provisions of the DCO Application (Refer to document EN010157/APP/6.3).
 - Do not scale from this drawing.



Rev	Date	By	Chkd	Appd	Authd
P04	29/10/25	JP	ZF	ZF	ZF
P03	28/10/25	JP	ZF	ZF	ZF
P02	08/09/25	CU	ZF	ZF	ZF
P01	10/02/25	JP	ZF	ZF	ZF

Client



Project Name

Peartree Hill Solar Farm

Drawing Title

Environmental Statement Volume 3, Figure 3.4: Indicative Environmental Masterplan Sheet 4 of 18

Scale at A1

1:2500

Status

DCO Application

PINS Number:
EN010157/APP/6.3

Drawing Name
0589-SHRSK-XX-XX-DR-L-1000

Coordinate System:
British National Grid

Rev
P04

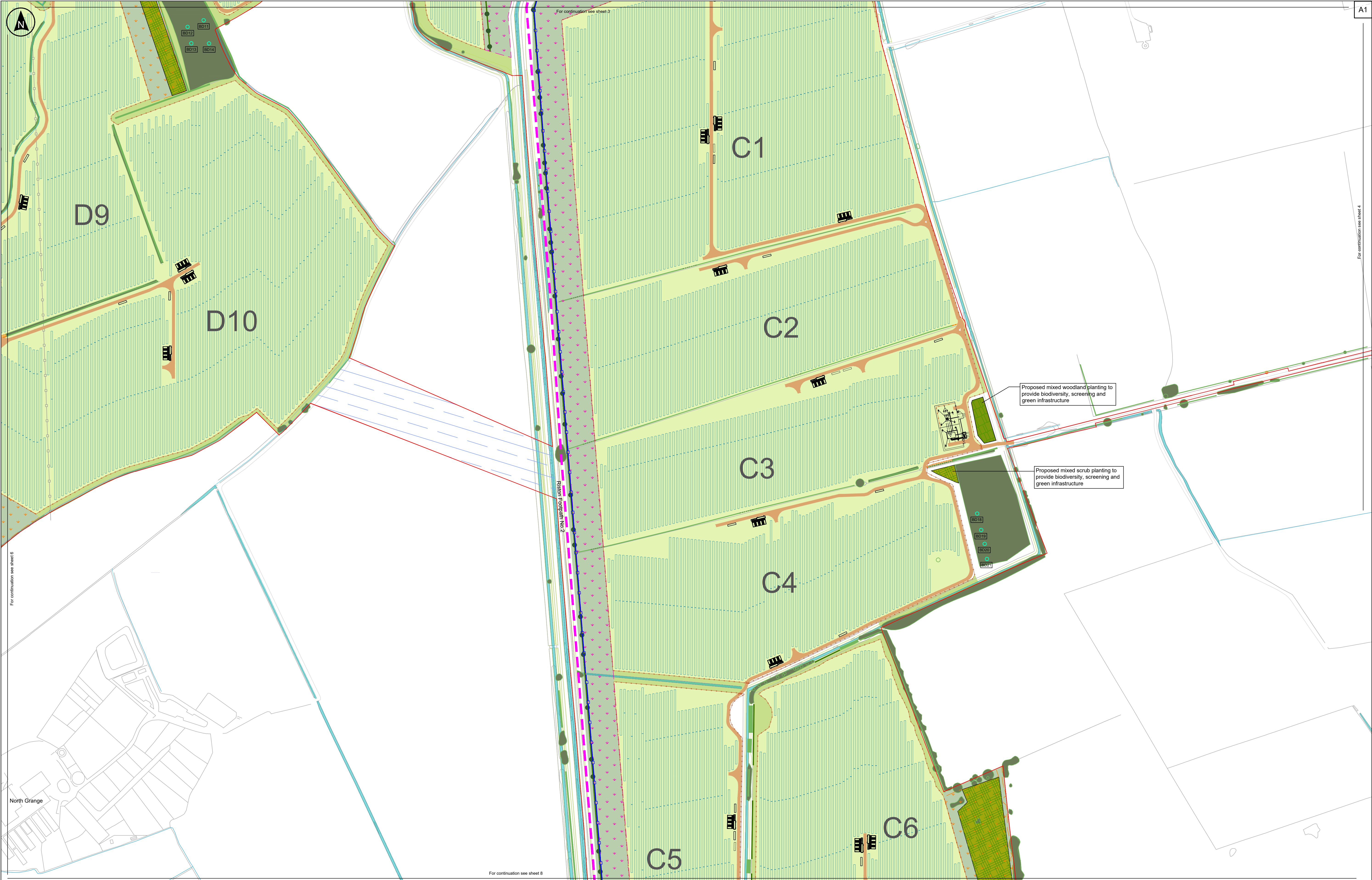

Key

Order Limits

Existing Features

Woodland, Trees and Hedgerows to be retained and protected

Trees and Hedgerows to be removed to allow for construction of Proposed Development

Public Right of Way

Watercourses and Waterbodies

Powerlines and Pylons

Proposed Development Features

Proposed Solar Panels

Proposed Internal Tracks

Proposed Hybrid Pack (Inverters, Converters, BESS Units)

Proposed Switch Gear/ Spares Container

Proposed On-site Substation

Proposed Perimeter Fencing

Proposed Post and Wire Fencing

Proposed Permissive Path (to be available for pedestrians only)

Interconnecting cable routes and grid connection cable route (Habitats to be reinstated following cable installation)

Proposed Individual Tree Planting

Proposed Mixed Woodland Planting

Proposed Mixed Scrub Planting

Proposed Species-rich Hedgerow Planting

Proposed Species-rich Infill/ Reinstatement Hedgerow Planting

Proposed Legume Rich Grassland: To establish a sward between the solar panels within the fenced areas (post initial implementation)

Proposed Field Margin Grassland: To provide habitat and food resources for wildlife. Mixes to be either Wild Bird Winter Seed or Legume Rich Grassland as recommended by Ecologist

Proposed Flower Rich/Wet Grassland: Within Biodiversity Mitigation & Enhancement Areas. Mixes to be either flower rich grassland or wet grassland as recommended by Ecologist and dependent on site conditions

Proposed Biodiversity Mitigation Area

Proposed Biodiversity Enhancement Area

Proposed bird box location (Refer to Appendix B in the Outline LEMP for box type)

Interconnecting cable routes and grid connection cable route (Habitats to be reinstated following cable installation)

Notes:

- Drawing is indicative only and not for construction.
- This drawing depicts the anticipated layout of the Proposed Development, exact details concerning the layout and dimensions of the Proposed Development will be determined and designed at detailed design stage in line with the provisions of the DCO Application (Refer to document EN010157/APP6.3).
- Do not scale from this drawing.

Rev	Date	By	Chkd	Appd	Authd
P04	29/10/25	JP	ZF	ZF	ZF
P03	28/10/25	JP	ZF	ZF	ZF
P02	08/09/25	CU	ZF	ZF	ZF
P01	10/02/25	JP	ZF	ZF	ZF

RWE

Designer

RSK

Client

Peartree Hill Solar Farm

Drawing Title

Environmental Statement Volume 3, Figure 3.4: Indicative Environmental Masterplan

Sheet 5 of 18

Scale at A1

1:2500

Status

DCO Application

PINS Number

EN010157/APP6.3

Drawing Name

0589-SHRSK-XX-XX-DR-L-1000

Coordinate System:

British National Grid

Rev

P04

The Base mapping is based upon Ordnance Survey (OS) data. Reproduced from Ordnance Survey maps by permission of Ordnance Survey on behalf of the controller of His Majesty's Stationery Office (HMSO). © Crown Copyright Ordnance Survey 2024. Licence number 0100031673.



Site Plan: Not to scale

Key

Order Limits

Existing Features

- Woodland, Trees and Hedgerows to be retained and protected
- Trees and Hedgerows to be removed to allow for construction of Proposed Development
- Public Right of Way

Proposed Development Features

- Watercourses and Waterbodies
- Powerlines and Pylons
- Proposed Solar Panels
- Proposed Internal Tracks
- Proposed Hybrid Pack (Inverters, Converters, BESS Units)
- Proposed Switch Gear/ Spares Container
- Proposed On-site Substation
- Proposed Perimeter Fencing
- Proposed Post and Wire Fencing
- Proposed Permissive Path (to be available for horse riders and pedestrians)
- Proposed Individual Tree Planting
- Proposed Mixed Scrub Planting
- Proposed Species-rich Hedgerow Planting
- Proposed Species-rich Infill/ Reinstatement Hedgerow Planting
- Proposed Legume Rich Grassland: To establish a sward between the solar panels within the fenced areas (post initial implementation)
- Proposed Field Margin Grassland: To provide habitat and food resources for wildlife. Mixes to be either Wild Bird Winter Seed or Legume Rich Grassland as recommended by Ecologist
- Proposed Flower Rich/Wet Grassland: Within Biodiversity Mitigation & Enhancement Areas. Mixes to be either flower rich grassland or wet grassland as recommended by Ecologist and dependent on site conditions
- Proposed Biodiversity Mitigation Area
- Proposed Biodiversity Enhancement Area
- Interconnecting cable routes and grid connection cable route (Habitats to be reinstated following cable installation)
- Proposed Interpretation Board
- Proposed Scope (indicative extent)
- Proposed bird box location (Refer to Appendix B in the Outline LEMP for box type)
- Proposed kestrel box location (Refer to Appendix B in the Outline LEMP for box type)
- Proposed barn owl box location (Refer to Appendix B in the Outline LEMP for box type)
- Proposed bat box location (Refer to Appendix B in the Outline LEMP for box type)

Notes:

- Drawing is indicative only and not for construction.
- This drawing depicts the anticipated layout of the Proposed Development, exact details concerning the layout and dimensions of the Proposed Development will be determined and designed at detailed design stage in line with the provisions of the DCO Application (Refer to document EN010157/APP06.3).
- Do not scale from this drawing.

Rev	Date	By	Chkd	Appd	Authd
P04	29/10/25	JP	ZF	ZF	ZF
P03	28/10/25	JP	ZF	ZF	ZF
P02	08/09/25	CU	ZF	ZF	ZF
P01	10/02/25	JP	ZF	ZF	ZF

Client

RWE

Designer

RSK

Project Name

Peartree Hill Solar Farm

Drawing Title

Environmental Statement Volume 3, Figure 3.4: Indicative Environmental Masterplan

Sheet 6 of 18

Scale at A1
1:2500

Status
DCO Application

PNS Number
EN010157/APP06.3

Drawing Name
0589-SHRSK-XX-XX-DR-L-1000

Coordinate System:
British National Grid

Rev
P04

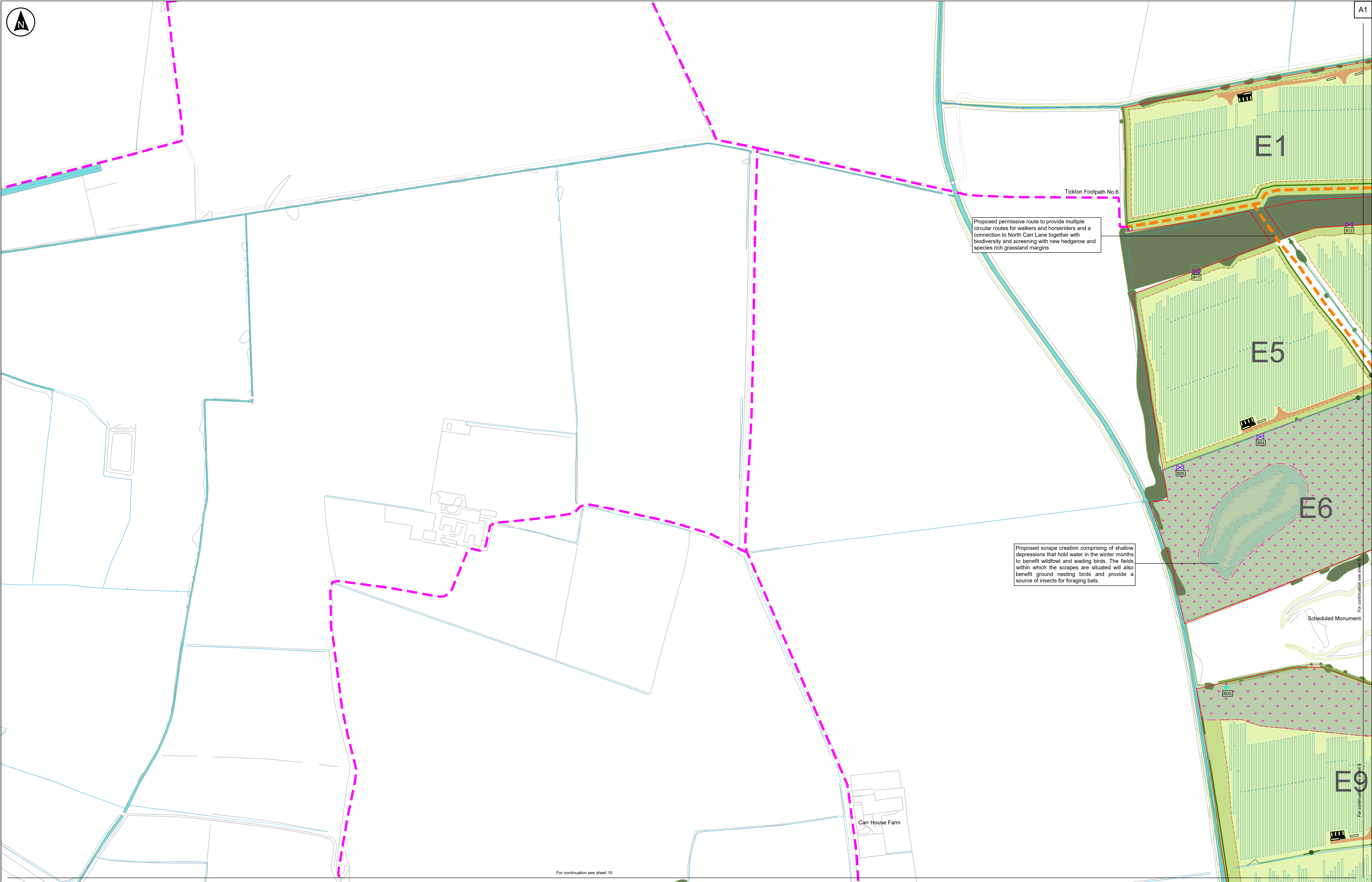

Site Plan: Not to scale

Key

Existing Features

- Order Limits
- Woodland, Trees and Hedgerows to be retained and protected
- Trees and Hedgerows to be removed to allow for construction of Proposed Development
- Public Right of Way

Proposed Development Features

- Watercourses and Waterbodies
- Powerlines and Pylons
- Proposed Solar Panels
- Proposed Internal Tracks
- Proposed Hybrid Pack (Inverters, Converters, BESS Units)
- Proposed Switch Gear/ Spares Container
- Proposed Perimeter Fencing
- Proposed Permissive Path (to be available for horse riders and pedestrians)
- Proposed Individual Tree Planting
- Proposed Species-rich Hedgerow Planting

Proposed Species-rich Infill/Reinstatement Hedgerow Planting

Proposed Legume Rich Grassland: To establish a sward between the solar panels within the fenced areas (post initial implementation)

Proposed Field Margin Grassland: To provide habitat and food resources for wildlife. Mixes to be either Wild Bird Winter Seed or Legume Rich Grassland as recommended by Ecologist

Proposed Flower Rich/Wet Grassland: Within Biodiversity Mitigation & Enhancement Areas. Mixes to be either flower rich grassland or wet grassland as recommended by Ecologist and dependent on site conditions

Proposed Interpretation Board

Proposed Biodiversity Mitigation Area

Proposed Scrape (indicative extent)

Proposed bat box location (Refer to Appendix E in the Outline LEMP for box type)

Proposed kestrel box location (Refer to Appendix B in the Outline LEMP for box type)

Notes:

- Drawing is indicative only and not for construction.
- This drawing depicts the anticipated layout of the Proposed Development, exact details concerning the layout and dimensions of the Proposed Development will be determined and designed at detailed design stage in line with the provisions of the DCO Application (Refer to document EN010157/APP/6.3).
- Do not scale from this drawing.

Rev	Date	By	Chkd	Appd	Authd
P04	29/10/25	JP	ZF	ZF	ZF
P03	28/10/25	JP	ZF	ZF	ZF
P02	08/09/25	CU	ZF	ZF	ZF
P01	10/02/25	JP	ZF	ZF	ZF

Client

RWE

Designer

RSK

Project Name

Peartree Hill Solar Farm

Drawing Title

Environmental Statement Volume 3, Figure 3.4: Indicative Environmental Masterplan Sheet 7 of 18

Scale at A1
1:2500

Coordinate System:
British National Grid

Status
DCO Application

PNS Number
EN010157/APP/6.3

Drawing Name
0589-SHRISK-XX-XX-DR-L-1000

Rev
P04



Site Plan: Not to scale

Key

Existing Features

- Order Limits
- Woodland, Trees and Hedgerows to be retained and protected
- Trees and Hedgerows to be removed to allow for construction of Proposed Development
- Public Right of Way

Proposed Development Features

- Watercourses and Waterbodies
- Powerlines and Pylons
- Proposed Solar Panels
- Proposed Internal Tracks
- Proposed Hybrid Pack (Inverters, Converters, BESS Units)
- Proposed Switch Gear/ Spares Container
- Proposed Perimeter Fencing
- Proposed Post and Wire Fencing
- Proposed Permissive Path (to be available for pedestrians only)
- Proposed Individual Tree Planting
- Proposed Mixed Woodland Planting
- Proposed Mixed Scrub Planting
- Proposed Species-rich Hedgerow Planting
- Proposed Species-rich Infill/ Reinstatement Hedgerow Planting
- Proposed Legume Rich Grassland: To establish a sward between the solar panels within the fenced areas (post initial implementation)
- Proposed Field Margin Grassland: To provide habitat and food resources for wildlife. Mixes to be either Wild Bird Winter Seed or Legume Rich Grassland as recommended by Ecologist
- Proposed Flower Rich/Wet Grassland: Within Biodiversity Mitigation & Enhancement Areas. Mixes to be either flower rich grassland or wet grassland as recommended by Ecologist and dependent on site conditions
- Proposed Biodiversity Mitigation Area
- Proposed Biodiversity Enhancement Area
- Proposed Interpretation Board
- Proposed bird box location (Refer to Appendix B in the Outline LEMP for box type)
- Proposed barn owl box location (Refer to Appendix B in the Outline LEMP for box type)
- Proposed bat box location (Refer to Appendix B in the Outline LEMP for box type)

Notes:

- Drawing is indicative only and not for construction.
- This drawing depicts the anticipated layout of the Proposed Development, exact details concerning the layout and dimensions of the Proposed Development will be determined and designed at detailed design stage in line with the provisions of the DCO Application (Refer to document EN010157/APP06.3).
- Do not scale from this drawing.

Rev	Date	By	Chkd	Appd	Authd
P04	29/10/25	JP	ZF	ZF	ZF
P03	28/10/25	JP	ZF	ZF	ZF
P02	08/09/25	CU	ZF	ZF	ZF
P01	10/02/25	JP	ZF	ZF	ZF

Client

RWE

Designer

RSK

Project Name

Peartree Hill Solar Farm

Drawing Title

Environmental Statement Volume 3, Figure 3.4: Indicative Environmental Masterplan Sheet 8 of 18

Scale at A1
1:2500

Status
DCO Application

PINS Number
EN010157/APP06.3

Drawing Name
0589-SHRBK-XX-XX-DR-L-1000

Coordinate System:
British National Grid

Rev
P04

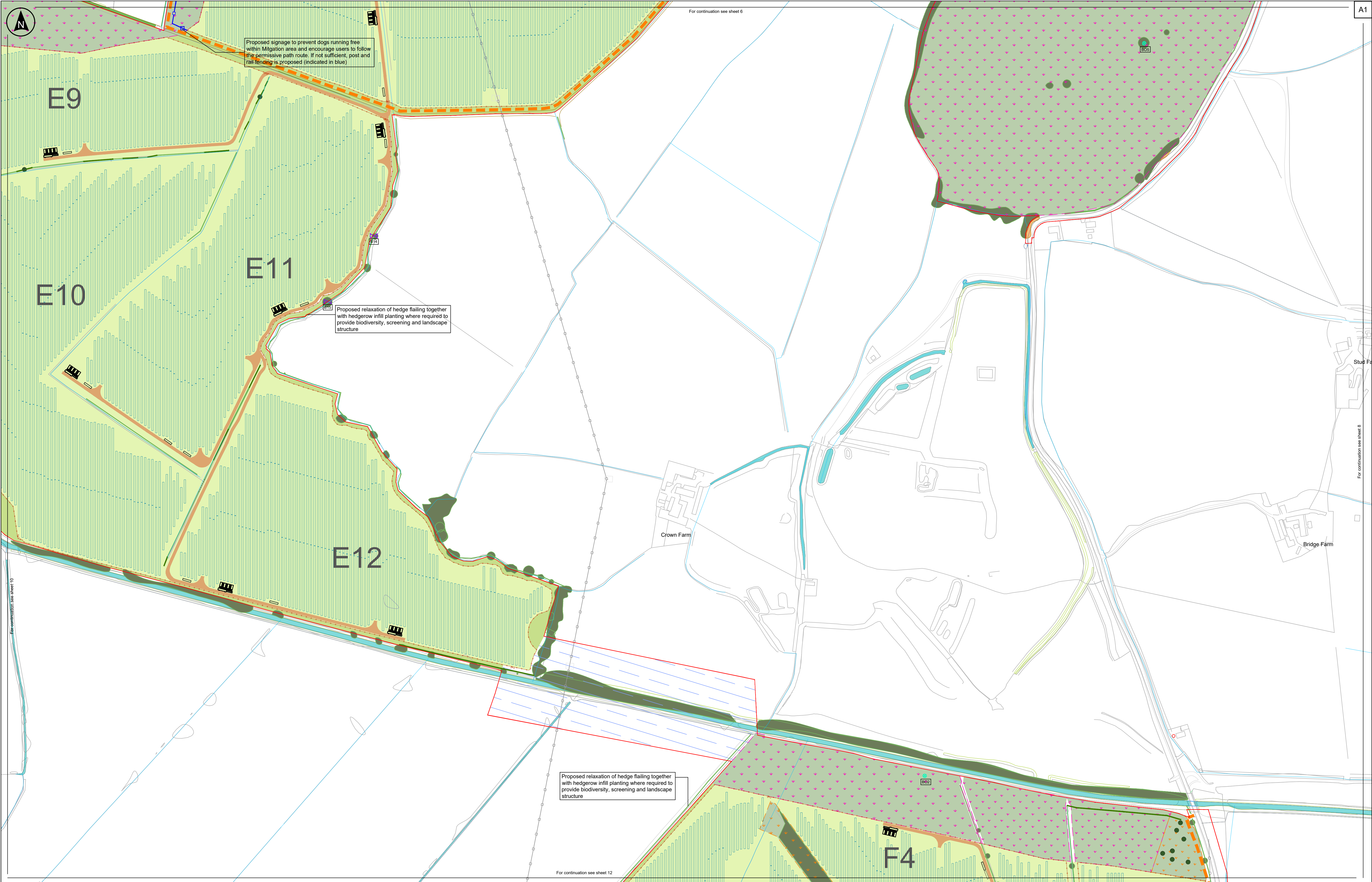

Site Plan: Not to scale

Key

Order Limits

Existing Features

- Woodland, Trees and Hedgerows to be retained and protected
- Trees and Hedgerows to be removed to allow for construction of Proposed Development
- Public Right of Way

Proposed Development Features

- Proposed Solar Panels
- Proposed Internal Tracks
- Proposed Hybrid Pack (Inverters, Converters, BESS Units)
- Proposed Switch Gear/ Spares Container
- Proposed Perimeter Fencing
- Proposed Post and Wire Fencing
- Proposed Permissive Path (to be available for horse riders and pedestrians)
- Interconnecting cable routes and grid connection cable route (Habitats to be reinstated following cable installation)
- Proposed Individual Tree Planting
- Proposed Mixed Woodland Planting
- Proposed Mixed Scrub Planting
- Proposed Species-rich Hedgerow Planting
- Proposed Species-rich Infill/ Reinstatement Hedgerow Planting
- Proposed Legume Rich Grassland: To establish a sward between the solar panels within the fenced areas (post initial implementation)
- Proposed Field Margin Grassland: To provide habitat and food resources for wildlife. Mixes to be either Wild Bird Winter Seed or Legume Rich Grassland as recommended by Ecologist
- Proposed Flower Rich/Wet Grassland: Mixes to be either flower rich grassland or wet grassland as recommended by Ecologist and dependent on site conditions
- Proposed Biodiversity Mitigation Area
- Proposed Biodiversity Enhancement Area
- Proposed barn owl box location (Refer to Appendix B in the Outline LEMP for box type)
- Proposed bat box location (Refer to Appendix B in the Outline LEMP for box type)

Notes:

- Drawing is indicative only and not for construction.
- This drawing depicts the anticipated layout of the Proposed Development, exact details concerning the layout and dimensions of the Proposed Development will be determined and designed at detailed design stage in line with the provisions of the DCO Application (Refer to document EN010157/APP06.3).
- Do not scale from this drawing.

For continuation see sheet 12

Rev	Date	By	Chkd	Appd	Authd
P04	29/10/25	JP	ZF	ZF	ZF
P03	28/10/25	JP	ZF	ZF	ZF
P02	08/09/25	CU	ZF	ZF	ZF
P01	10/02/25	JP	ZF	ZF	ZF

Client

RWE

Designer

RSK

Project Name

Peartree Hill Solar Farm

Drawing Title

Environmental Statement Volume 3, Figure 3.4: Indicative Masterplan

Sheet 9 of 18

Scale at A1

1:2500

Status

DCO Application

PINS Number

EN010157/APP06.3

Drawing Name

0589-SHRBK-XX-XX-DR-L-1000

Coordinate System:

British National Grid

Rev

P04

The Base mapping is based upon Ordnance Survey (OS) data. Reproduced from Ordnance Survey maps by permission of Ordnance Survey on behalf of the controller of His Majesty's Stationery Office (HMSO). © Crown Copyright Ordnance Survey 2024. Licence number 0100031673.

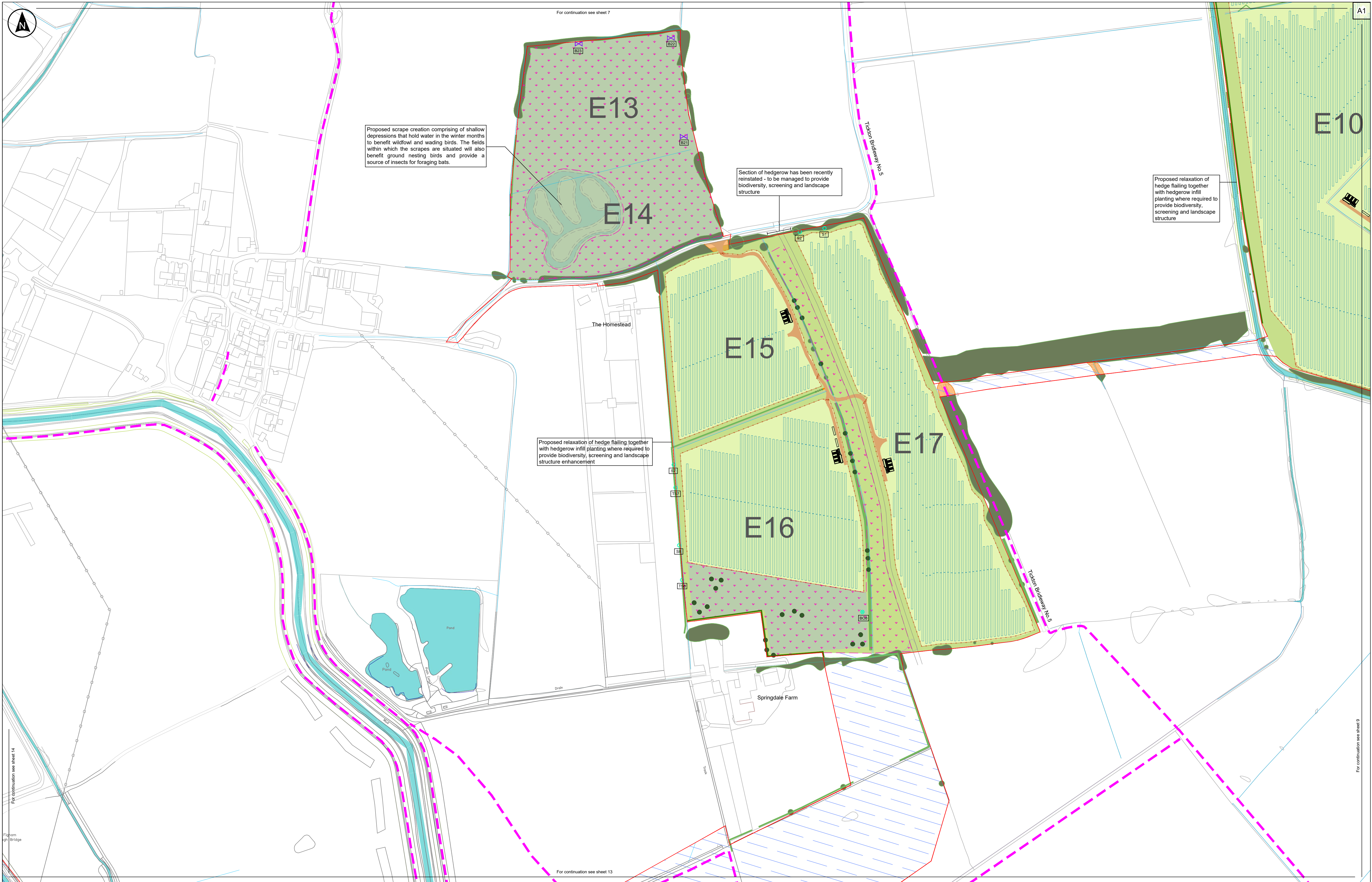

Site Plan: Not to scale

Key

Existing Features

- Order Limits
- Watercourses and Waterbodies
- Powerlines and Pylons
- Proposed Development Features
- Proposed Solar Panels
- Proposed Internal Tracks
- Proposed Hybrid Pack (Inverters, Converters, BESS Units)
- Proposed Species-rich Hedgerow Planting
- Proposed Species-rich Infill/Reinstatement Hedgerow Planting
- Proposed Legume Rich Grassland: To establish a sward between the solar panels within the fenced areas (post initial implementation)
- Proposed Field Margin Grassland: To provide habitat and food resources for wildlife. Moss to be either Wild Bird Winter Seed or Legume Rich Grassland as recommended by Ecologist
- Proposed Flower Rich/Wet Grassland: Within Biodiversity Mitigation & Enhancement Areas. Mixes to be either flower rich grassland or wet grassland as recommended by Ecologist and dependent on site conditions
- Proposed Biodiversity Mitigation Area
- Proposed Scrape (Indicative extent)
- Interconnecting cable routes and grid connection cable route (Habitats to be reinstated following cable installation)
- Proposed bird box location (Refer to Appendix B in the Outline LEMP for box type)
- Proposed barn owl box location (Refer to Appendix B in the Outline LEMP for box type)
- Proposed bat box location (Refer to Appendix B in the Outline LEMP for box type)

Notes:

- Drawing is indicative only and not for construction.
- This drawing depicts the anticipated layout of the Proposed Development, exact details concerning the layout and dimensions of the Proposed Development will be determined and designed at detailed design stage in line with the provisions of the DCO Application (Refer to document EN010157/APP06.3).
- Do not scale from this drawing.

Rev	Date	By	Chkd	Appd	Authd
P04	29/10/25	JP	ZF	ZF	ZF
P03	28/10/25	JP	ZF	ZF	ZF
P02	08/09/25	CU	ZF	ZF	ZF
P01	10/02/25	JP	ZF	ZF	ZF

Client

RWE

Designer

RSK

Project Name

Peartree Hill Solar Farm

Drawing Title

Environmental Statement Volume 3, Figure 3.4: Indicative Environmental Masterplan Sheet 10 of 18

Scale at A1
1:2500

Status
DCO Application

PINS Number
EN010157/APP/6.3

Drawing Name
0589-SHRSK-XX-XX-DR-L-1000

Coordinate System:
British National Grid

Rev
P04

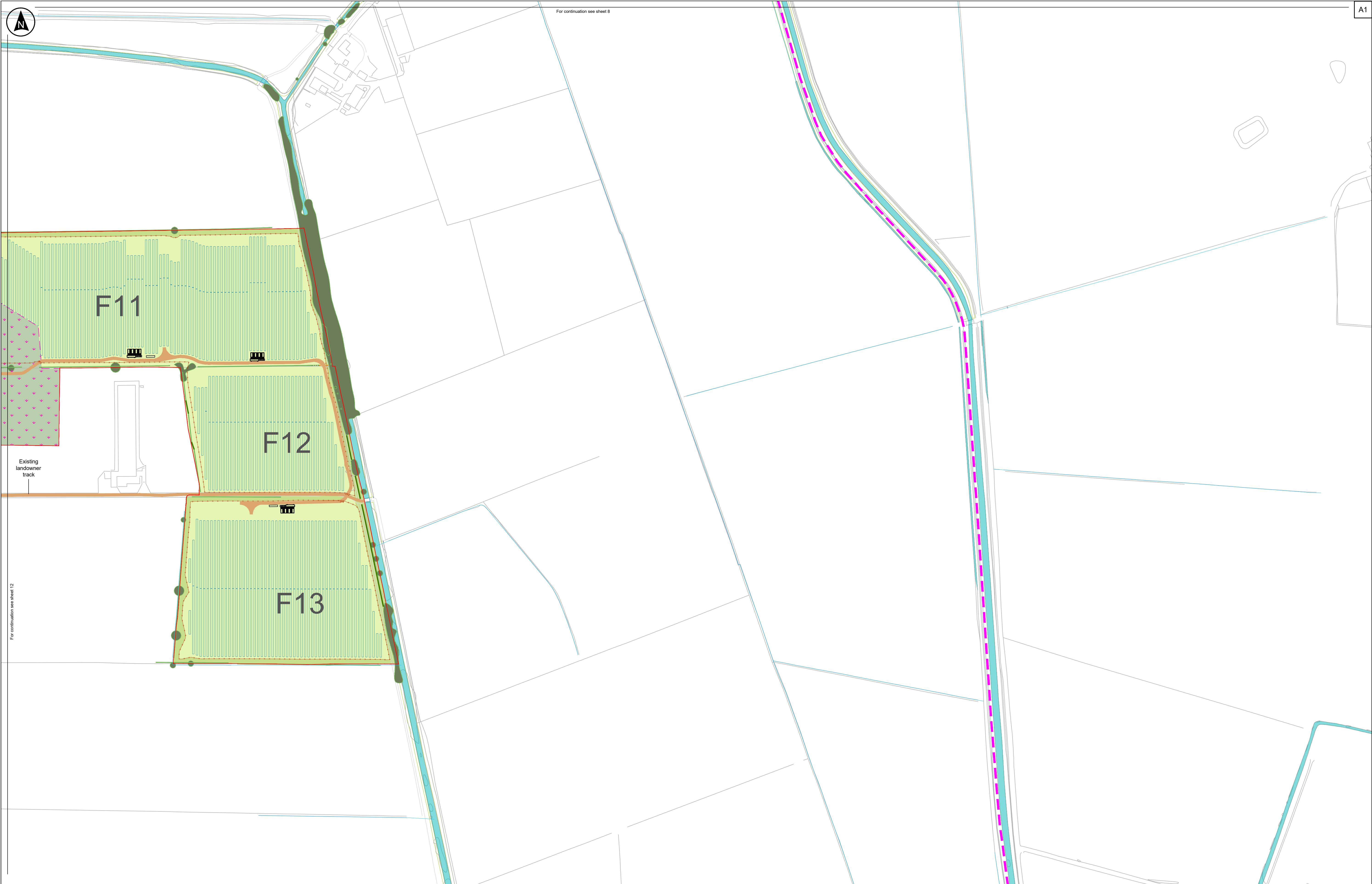

Site Plan: Not to scale

Key

Order Limits

Existing Features

Woodland, Trees and Hedgerows to be retained and protected

Trees and Hedgerows to be removed to allow for construction of Proposed Development

Public Right of Way

Existing Landowner Tracks

Watercourses and Waterbodies

Powerlines and Pylons

Proposed Development Features

Proposed Solar Panels

Proposed Internal Tracks

Proposed Hybrid Pack (Inverters, Converters, BESS Units)

Proposed Switch Gear/ Spares Container

Proposed Perimeter Fencing

Proposed Individual Tree Planting

Proposed Mixed Woodland Planting

Proposed Mixed Scrub Planting

Proposed Species-rich Hedgerow Planting

Proposed Species-rich Infill/Reinstatement Hedgerow Planting

Proposed Legume Rich Grassland: To establish a sward between the solar panels within the fenced areas (post initial implementation)

Proposed Field Margin Grassland: To provide habitat and food resources for wildlife. Mixes to be either Wild Bird Winter Seed or Legume Rich Grassland as recommended by Ecologist

Proposed Flower Rich/Wet Grassland: Within Biodiversity Mitigation & Enhancement Areas. Mixes to be either flower rich grassland or wet grassland as recommended by Ecologist and dependent on site conditions

Proposed Biodiversity Mitigation Area

Notes:

- Drawing is indicative only and not for construction.
- This drawing depicts the anticipated layout of the Proposed Development, exact details concerning the layout and dimensions of the Proposed Development will be determined and designed at detailed design stage in line with the provisions of the DCO Application (Refer to document EN010157/APP06.3).
- Do not scale from this drawing.

Rev	Date	By	Chkd	Appd	Authd
P04	29/10/25	JP	ZF	ZF	ZF
P03	28/10/25	JP	ZF	ZF	ZF
P02	08/09/25	CU	ZF	ZF	ZF
P01	10/02/25	JP	ZF	ZF	ZF

Client

Designer

Project Name

Peartree Hill Solar Farm

Drawing Title

Environmental Statement Volume 3, Figure 3.4: Indicative Environmental Masterplan

Sheet 11 of 18

Scale at A1
1:2500

Status
DCO Application

PINS Number
EN010157/APP06.3

Drawing Name
0589-SHRSK-XX-XX-DR-L-1000

Coordinate System:
British National Grid

Rev	Rev
P04	P04

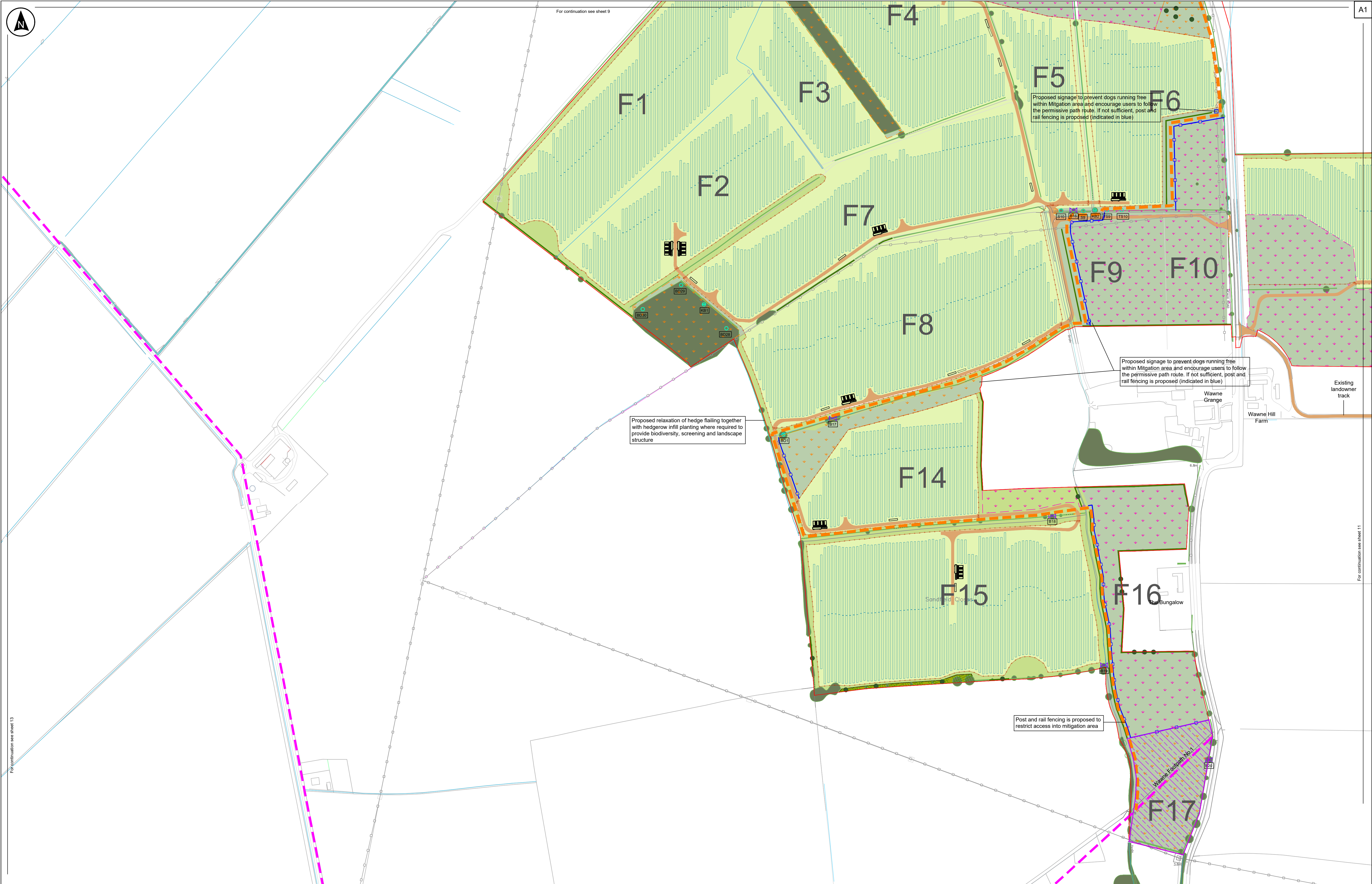

Site Plan: Not to scale

Key

Existing Features

- Order Limits
- Woodland, Trees and Hedgerows to be retained and protected
- Trees and Hedgerows to be removed to allow for construction of Proposed Development
- Public Right of Way
- Existing Landowner Tracks

Proposed Development Features

- Watercourses and Waterbodies
- Powerlines and Pylons
- Proposed Solar Panels
- Proposed Internal Tracks
- Proposed Hybrid Pack (Inverters, Converters, BESS Units)
- Proposed Switch Gear/ Spares Container
- Proposed Perimeter Fencing
- Proposed Post and Wire Fencing
- Proposed Permissive Path (to be available for pedestrians only)
- Proposed Individual Tree Planting
- Proposed Mixed Scrub Planting
- Proposed Species-rich Hedgerow Planting
- Proposed Species-rich Infill/Reinstatement Hedgerow Planting
- Proposed Legume Rich Grassland: To establish a sward between the solar panels within the fenced areas (post initial implementation)
- Proposed Field Margin Grassland: To provide habitat and food resources for wildlife. Mixes to be either Wild Bird Winter Seed or Legume Rich Grassland as recommended by Ecologist
- Proposed Flower Rich/Wet Grassland: Within Biodiversity Mitigation & Enhancement Areas. Mixes to be either flower rich grassland or wet grassland as recommended by Ecologist
- Area under consideration for community accessible land (Refer to the Outline Landscape and Ecological Management Plan [EN010157/APP17.3] for more information)
- Proposed Biodiversity Mitigation Area
- Proposed Biodiversity Enhancement Area
- Proposed bird box location (Refer to Appendix B in the Outline LEMP for box type)

Proposed bird box location (Refer to Appendix B in the Outline LEMP for box type)

- Proposed barn owl box location (Refer to Appendix B in the Outline LEMP for box type)
- Proposed kestrel box location (Refer to Appendix B in the Outline LEMP for box type)
- Proposed bat box location (Refer to Appendix B in the Outline LEMP for box type)

Notes:

- Drawing is indicative only and not for construction.
- This drawing depicts the anticipated layout of the Proposed Development, exact details concerning the layout and dimensions of the Proposed Development will be determined and designed at detailed design stage in line with the provisions of the DCO Application (Refer to document EN010157/APP16.3).
- Do not scale from this drawing.

Rev	Date	By	Chkd	Appd	Authd
P04	29/10/25	JP	ZF	ZF	ZF
P03	28/10/25	JP	ZF	ZF	ZF
P02	08/09/25	CU	ZF	ZF	ZF
P01	10/02/25	JP	ZF	ZF	ZF

Client

RWE

Designer

RSK

Project Name

Peartree Hill Solar Farm

Drawing Title

Environmental Statement Volume 3, Figure 3.4: Indicative Environmental Masterplan Sheet 12 of 18

Scale at A1: 1:2500

Status: DCO Application

PINS Number: EN010157/APP16.3

Drawing Name: 0589-SHRBK-XX-XX-DR-L-1000

Coordinate System: British National Grid

Rev	P04
-----	-----

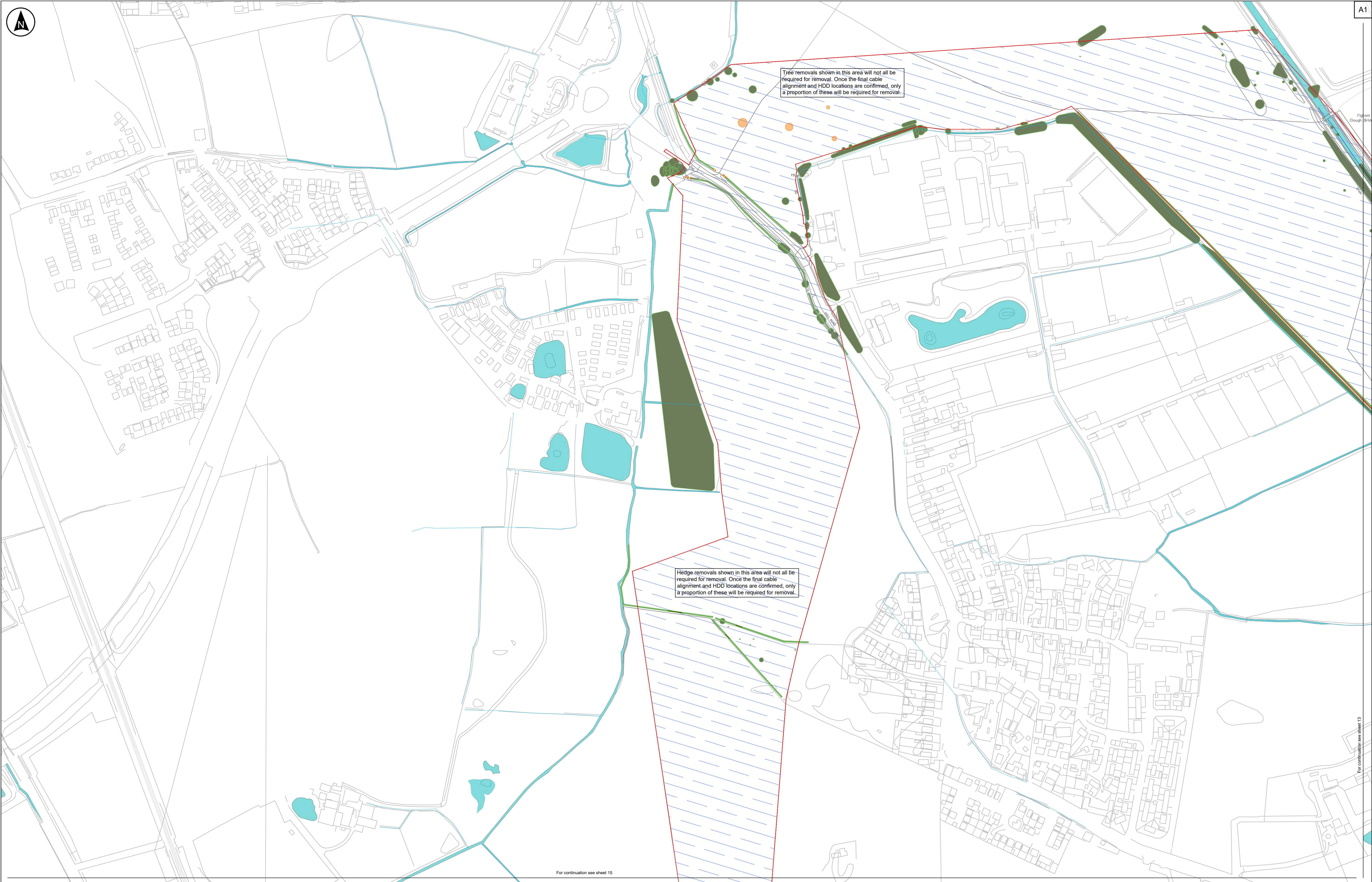

Site Plan: Not to scale

The Base mapping is based upon Ordnance Survey (OS) data. Reproduced from Ordnance Survey maps by permission of Ordnance Survey on behalf of the controller of His Majesty's Stationery Office (HMSO). © Crown Copyright Ordnance Survey 2024. Licence number 0100031673.

Notes:

- Drawing is indicative only and not for construction.
- This drawing depicts the anticipated layout of the Proposed Development, exact details concerning the layout and dimensions of the Proposed Development will be determined and designed at detailed design stage in line with the provisions of the DCO Application (Refer to document EN010157/APP/6.3).
- Do not scale from this drawing.

Rev	Date	By	Chkd	Appd	Authd
P04	29/10/25	JP	ZF	ZF	ZF
P03	28/10/25	JP	ZF	ZF	ZF
P02	08/09/25	CU	ZF	ZF	ZF
P01	10/02/25	JP	ZF	ZF	ZF

Client

RWE

Designer

RSK

Project Name

Peartree Hill Solar Farm

Drawing Title

Environmental Statement Volume 3, Figure 3.4: Indicative Environmental Masterplan Sheet 14 of 18

Scale at A1
1:2500

Status
DCO Application

PINS Number
EN010157/APP/6.3

Drawing Name
0589-SHRBK-XX-XX-DR-L-1000

Coordinate System:
British National Grid

Rev
P04



A1

For continuation see sheet 14

Hedge/tree removals shown in this area will not all be required for removal. Once the final cable alignment and HDD locations are confirmed, only a proportion of these will be required for removal.

For continuation see sheet 16

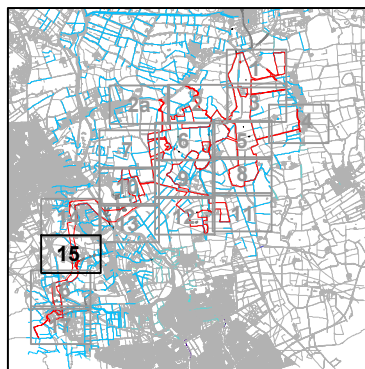

Site Plan: Not to scale

Key	
	Order Limits
Existing Features	
	Woodland, Trees and Hedgerows to be retained and protected
	Trees and Hedgerows to be removed to allow for construction of Proposed Development
	Public Right of Way
Proposed Development Features	
	Interconnecting cable routes and grid connection cable route (Habitats to be reinstated following cable installation)
	Proposed Species-rich Hedgerow Planting
	Watercourses and Waterbodies
	Powerlines and Pylons

- Notes:
- Drawing is indicative only and not for construction.
 - This drawing depicts the anticipated layout of the Proposed Development, exact details concerning the layout and dimensions of the Proposed Development will be determined and designed at detailed design stage in line with the provisions of the DCO Application (Refer to document EN010157/APP/6.3).
 - Do not scale from this drawing.

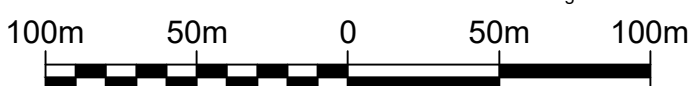

Rev	Date	By	Chkd	Appd	Authd
P04	29/10/25	JP	ZF	ZF	ZF
P03	28/10/25	JP	ZF	ZF	ZF
P02	08/09/25	CU	ZF	ZF	ZF
P01	10/02/25	JP	ZF	ZF	ZF

Client



Project Name

Peartree Hill Solar Farm

Drawing Title

Environmental Statement Volume 3, Figure 3.4: Indicative Environmental Masterplan Sheet 15 of 18

Scale at A1

1:2500

Coordinate System:

British National Grid

Status

DCO Application

PINS Number:
EN010157/APP/6.3

Drawing Name
0589-SHRSK-XX-XX-DR-L-1000

Rev

P04

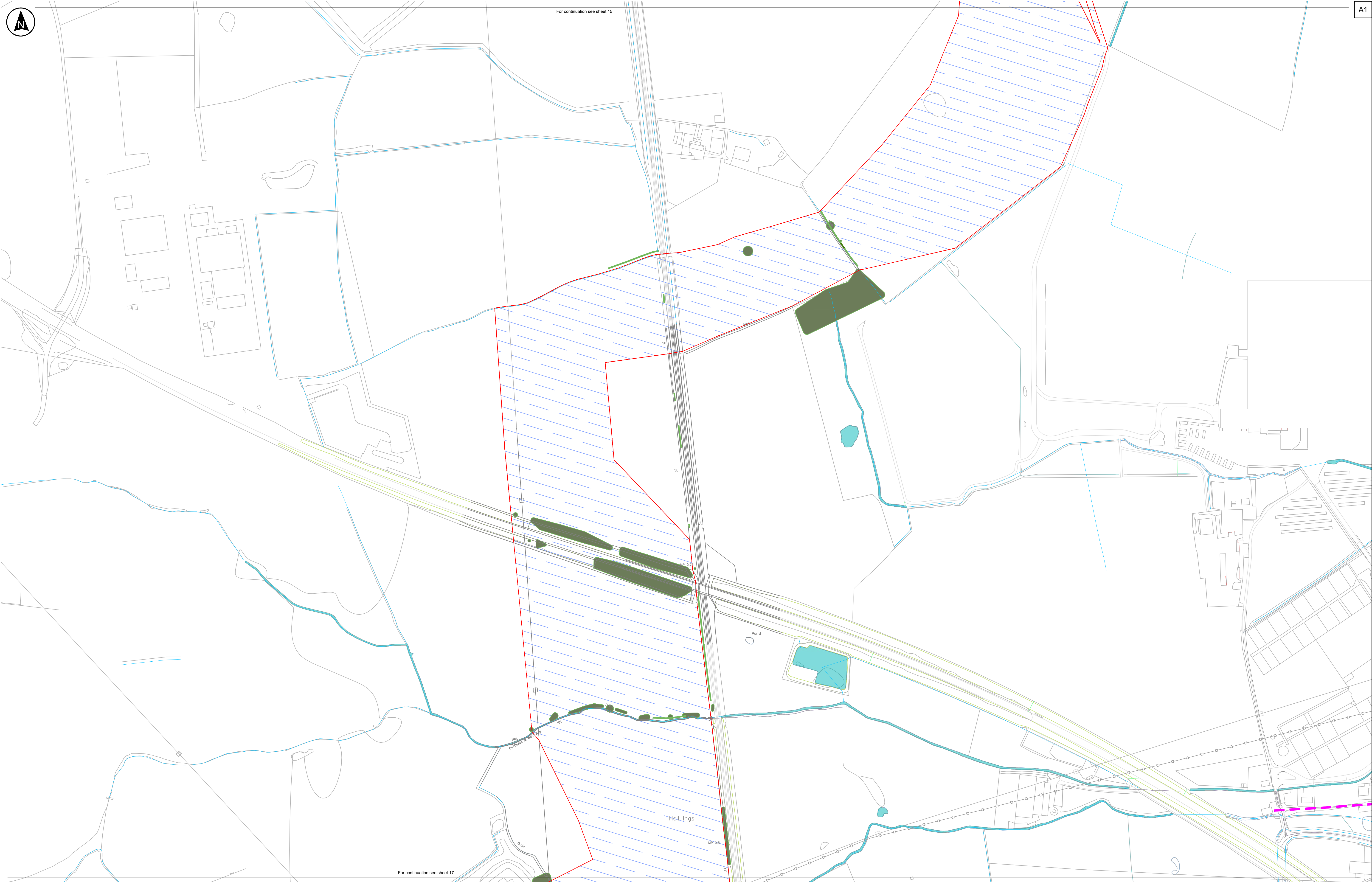

Site Plan: Not to scale

The Base mapping is based upon Ordnance Survey (OS) data. Reproduced from Ordnance Survey maps by permission of Ordnance Survey on behalf of the controller of His Majesty's Stationery Office (HMSO). © Crown Copyright Ordnance Survey 2024. Licence number 0100031673.

Key

Order Limits

Existing Features

- Woodland, Trees and Hedgerows to be retained and protected
- Trees and Hedgerows to be removed to allow for construction of Proposed Development
- Public Right of Way

Proposed Development Features

- Interconnecting cable routes and grid connection cable route (Habitats to be reinstated following cable installation)
- Proposed Species-rich Hedgerow Planting

Watercourses and Waterbodies

Powerlines and Pylons

Notes:

- Drawing is indicative only and not for construction.
- This drawing depicts the anticipated layout of the Proposed Development, exact details concerning the layout and dimensions of the Proposed Development will be determined and designed at detailed design stage in line with the provisions of the DCO Application (Refer to document EN010157/APP/6.3).
- Do not scale from this drawing.

Rev	Date	By	Chkd	Appd	Authd
P04	29/10/25	JP	ZF	ZF	ZF
P03	28/10/25	JP	ZF	ZF	ZF
P02	08/09/25	CU	ZF	ZF	ZF
P01	10/02/25	JP	ZF	ZF	ZF

Client

RWE

Designer

RSK

Project Name

Peartree Hill Solar Farm

Drawing Title

Environmental Statement Volume 3, Figure 3.4: Indicative Environmental Masterplan

Sheet 16 of 18

Scale at A1
1:2500

Status
DCO Application

PINS Number
EN010157/APP/6.3

Drawing Name
0589-SHRBK-XX-XX-DR-L-1000

Coordinate System:
British National Grid

Rev
P04



Site Plan: Not to scale

Key

Order Limits

Existing Features

- Woodland, Trees and Hedgerows to be retained and protected
- Trees and Hedgerows to be removed to allow for construction of Proposed Development
- Public Right of Way

Proposed Development Features

- Interconnecting cable routes and grid connection cable route (Habitats to be reinstated following cable installation)
- Proposed Species-rich Hedgerow Planting

Watercourses and Waterbodies

Powerlines and Pylons

Notes:

- Drawing is indicative only and not for construction.
- This drawing depicts the anticipated layout of the Proposed Development, exact details concerning the layout and dimensions of the Proposed Development will be determined and designed at detailed design stage in line with the provisions of the DCO Application (Refer to document EN010157/APP/6.3).
- Do not scale from this drawing.

Rev	Date	By	Chkd	Appd	Authd
P04	29/10/25	JP	ZF	ZF	ZF
P03	28/10/25	JP	ZF	ZF	ZF
P02	08/09/25	CU	ZF	ZF	ZF
P01	10/02/25	JP	ZF	ZF	ZF

Client

RWE

Designer

RSK

Project Name

Peartree Hill Solar Farm

Drawing Title

Environmental Statement Volume 3, Figure 3.4: Indicative Environmental Masterplan Sheet 17 of 18

Scale at A1
1:2500

Status
DCO Application

PINS Number
EN010157/APP/6.3

Drawing Name
0589-SHRBK-XX-XX-DR-L-1000

Coordinate System:
British National Grid

Rev
P04

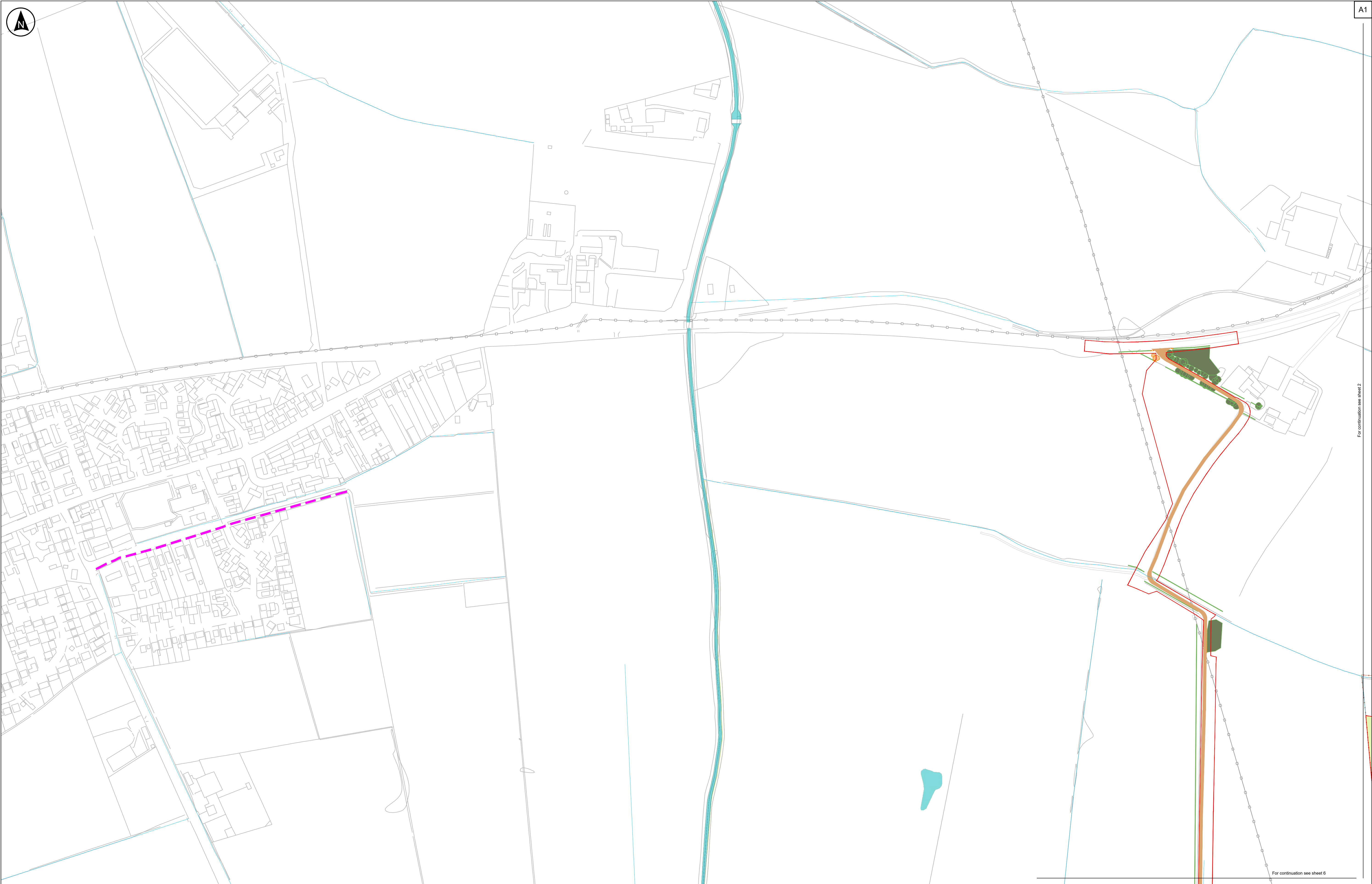

Site Plan: Not to scale

Key

	Order Limits
	Existing Features
	Woodland, Trees and Hedgerows to be retained and protected
	Trees and Hedgerows to be removed to allow for construction of Proposed Development
	Watercourses and Waterbodies
	Powerlines and Pylons
	Public Right of Way

Notes:

- Drawing is indicative only and not for construction.
- This drawing depicts the anticipated layout of the Proposed Development, exact details concerning the layout and dimensions of the Proposed Development will be determined and designed at detailed design stage in line with the provisions of the DCO Application (Refer to document EN010157/APP/6.3).
- Do not scale from this drawing.

P03	28/10/25	JP	ZF	ZF	ZF
P02	08/09/25	CU	ZF	ZF	ZF
P01	10/02/25	JP	ZF	ZF	ZF
Rev	Date	By	Chkd	Appd	Authd

Client

Designer

Project Name

Peartree Hill Solar Farm

Drawing Title

Environmental Statement Volume 3, Figure 3.4: Indicative Environmental Masterplan Sheet 2a of 18

Scale at A1
1:2500

Status
DCO Application

PINS Number
EN010157/APP/6.3

Drawing Name
0589-SHRSK-XX-XX-DR-L-1000

Coordinate System:
British National Grid

Rev	P03
-----	-----

For continuation see sheet 2

For continuation see sheet 6

RWE Renewables UK Limited

Windmill Hill Business Park,
Whitehill Way,
Swindon,
Wiltshire,
England,
SN5 6PB
www.rwe.com